

## WHY imageCLASS?

# THE PRINTING EXPERIENCE YOU NEED FROM THE BRAND YOU CAN TRUST.

Canon's business-oriented lineup of office products allow employees to seamlessly print and scan documents, whether they're working from the corporate office, their home office, or a combination of both. The similar user experience and ease of operation of the imageRUNNER ADVANCE multifunction printers in the office and the desktop imageCLASS multifunction printer at home make for a smooth transition between the two work environments. This comprehensive solution delivers many benefits, including optimized workflows, low operating costs, minimal change management, and devices that can accommodate varied user needs. And when you include Canon's uniFLOW output management software, you further enable fleet-wide device authentication and cost management. The end result is a print and scan infrastructure that's flexible, has more security controls, and is built for the future of work.



# imageCLASS TECHNOLOGY

Canon technologies and solutions deliver value to organizations through people-centric design, integrated workflow support, advanced control, brilliant performance, and eco-conscious responsibility. By working together, Canon can help you improve your business operations.



- Supports certain compatible mobile solutions for printing and scanning
- Allows scanning to various destinations
- Delivers quick first-print-out times
- Offers a unique, customized device experience with Application Library
- More secure scanning directly into Dropbox, Google Drive™, Box, Microsoft OneDrive®/OneDrive® for Business, and Evernote® via uniFLOW Online



- Helps reduce the confidential document loss risk with no HDD/ Document Storage
- Security settings exportable through imageWARE Enterprise Management Console DCM
- Secure print management features
- Administrator control
- Department-level tracking
- Verify System at Startup is a process to help verify the validity of the device firmware and Application Library from unauthorized modifications



- Optional uniFLOW or uniFLOW Online provide full accounting and reporting
- Service parts are designed for machine's life cycle to help minimize the need for maintenance and potentially help reduce service calls
- High-capacity, all-in-one cartridges help minimize overall supply costs



- Designed for quick, easy deployment
- Remote diagnostics for rapid service response
- Easy monitoring and management of devices
- Generic drivers common with imageRUNNER ADVANCE Series



- Canon's signature reliability and engine technologies help keep productivity high and minimize impact on support resources
- Designed to achieve maximum uptime; status notifications help you keep supplies replenished
- Intuitive animations for common tasks like consumables replacement



- ENERGY STAR® certified and EPEAT® rated\*
- Cartridge recycling program
- A combination of fusing technologies and low-melting-point toner minimizes power requirements and helps achieve lower energy consumption

\* For the latest EPEAT ratings (Gold/Silver/Bronze), please visit [epeat.net](http://epeat.net).

NOTE: Some features vary by model. Refer to product brochures for more details.

# ALIGNMENT WITH imageRUNNER ADVANCE

By combining imageCLASS and imageRUNNER ADVANCE products into the same fleet, you can receive the following benefits.

## CONTROL

- Track usage and performance across the fleet with optional uniFLOW, uniFLOW Online, or uniFLOW Online Express.

## SECURITY FEATURES

- Utilize a common software platform for establishing and distributing security settings through imageWARE Enterprise Management Console.

## USABILITY

- Experience easy navigation with large color screens that share a common touch interface and device iconography.

## INSTALLATION AND SERVICEABILITY

- Help reduce administration burden by managing errors, jams, alarms, and meters through imageWARE Remote and the mobile Snapshot application.
- Install common drivers across UFR II, PCL, and PostScript.

## QUALITY

- Proven reliability and core engine technologies can help keep productivity high and minimize the impact on support resources.



Color imageCLASS X MF1127C

imageCLASS  
imageRUNNER  
ADVANCE DX



imageRUNNER ADVANCE  
DX C5700 Series



5" Color Touchscreen\*†

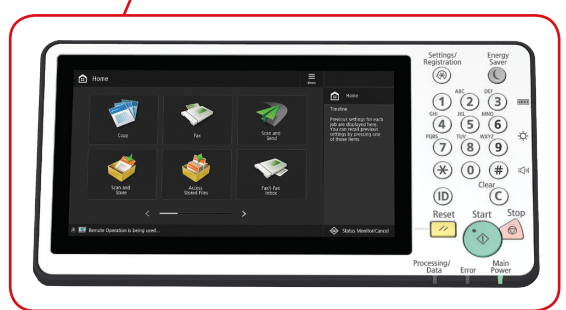

10.1" Color Touchscreen\*

\* Doesn't reflect actual size.

† Available on the imageCLASS MF543dw and imageCLASS X MF1238/MF1127C/LBP1238/LBP1127C.

NOTE: Some features vary by model; refer to individual product brochures for more details.

# imageCLASS AND uniFLOW

Integration with uniFLOW or uniFLOW Online allows employees to seamlessly print and scan documents, whether they're working from a home office, a corporate office, or combination of both. This approach can help maximize the value of printers and multifunction devices with your organization.

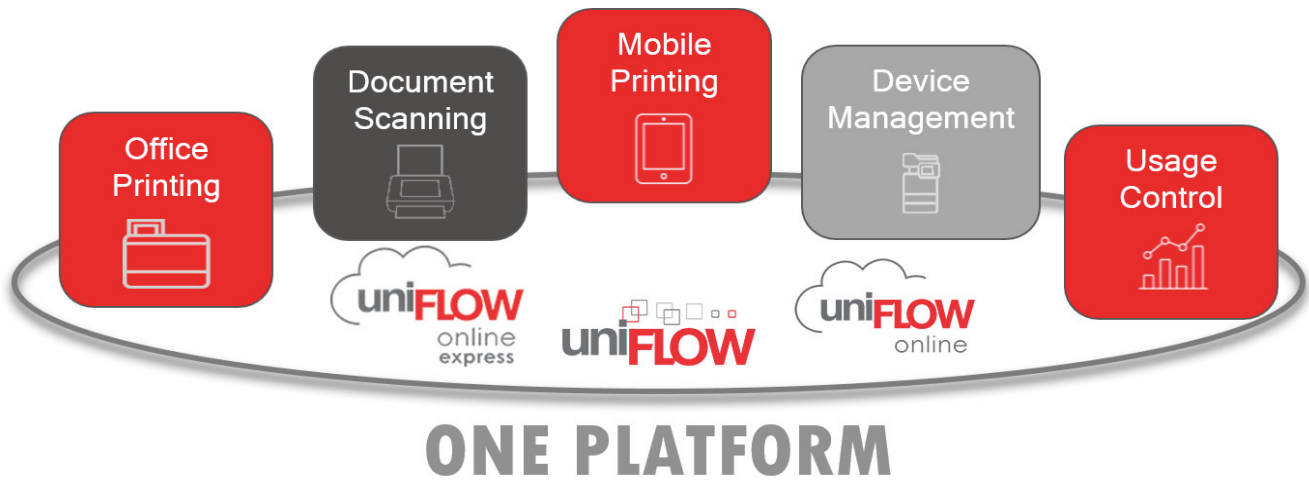

Experience the advantage of integrating with uniFLOW or uniFLOW Online with the following benefits.



**User Authentication**

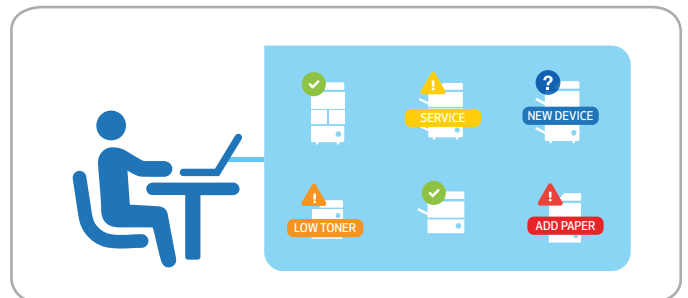

**Device Management**

## Greater and more detailed security features ...

- Manage user access to the device with unique user log-ins.
- Provide visitor temporary guest access that will automatically expire overnight.
- Release print jobs at any connected device using authentication.
- Customize job details to show job name, user name, job date, etc. at the device and manage individual print and scan jobs.

## Greater control over costs and usage ...

- Administer specific uniFLOW features or workflows to the devices.
- Manage a large-volume of users and devices in a hybrid work environment.
- Allows cost limits to be administered to users or groups.
- Manage contactless printing with uniFLOW Mobile App.\*

\* For more information, including compatibility, please visit <https://www.usa.canon.com/mobile-app>.

**NOTE:** Ask your Canon sales representative for more information. Some features vary by model; refer to individual product brochures for more details.

# imageCLASS PRODUCT PORTFOLIO



## imageCLASS X MF1127C COLOR LASER MFP PRINT, SCAN, COPY, FAX

- Up to 28 ppm
- 300 Sheets (Std.); 850 Sheets (Max.)
- 750 - 4K Recommended Monthly Page Volume
- All-in-One Toner Cartridge  
High Capacity: 7.6K/5.9K Sheets (Black/Color)



## imageCLASS X MF1238 BW LASER MFP PRINT, SCAN, COPY, FAX

- Up to 40 ppm
- 350 Sheets (Std.); 900 Sheets (Max.)
- 750 - 4K Recommended Monthly Page Volume
- All-in-One Toner Cartridge  
High Capacity: 11K Sheets



## imageCLASS MF543dw BW LASER MFP PRINT, SCAN, COPY, FAX

- Up to 45 ppm
- 650 Sheets (Std.); 2,300 Sheets (Max.)
- 2K - 7.5K Recommended Monthly Page Volume
- All-in-One Toner Cartridge  
High Capacity: 21K Sheets



## imageCLASS X LBP1127C COLOR LASER PRINTER

- Up to 28 ppm
- 300 Sheets (Std.); 850 Sheets (Max.)
- 750 - 4K Recommended Monthly Page Volume;
- All-in-One Toner Cartridge  
High Capacity: 7.6K/5.9K Sheets (Black/Color)



## imageCLASS X LBP1238 BW LASER PRINTER

- Up to 40 ppm
- 350 Sheets (Std.); 900 Sheets (Max.)
- 750 - 4K Recommended Monthly Page Volume
- All-in-One Toner Cartridge  
High Capacity: 11K Sheets



## imageCLASS LBP325dn BW LASER PRINTER

- Up to 45 ppm
- 650 Sheets (Std.); 2,300 Sheets (Max.)
- 2K - 7.5K Recommended Monthly Page Volume
- All-in-One Toner Cartridge  
High Capacity: 21K Sheets



Shown with optional cassettes and cabinet.

## imageCLASS LBP712Cdn COLOR LASER PRINTER

- Up to 40 ppm
- 650 Sheets (Std.); 2,300 Sheets (Max.)
- 1K - 7K Recommended Monthly Page Volume
- Toner Cartridge  
High Capacity: 12.5K/10K Sheets (Black/Color)



Shown with optional cassettes and stand.

## imageCLASS LBP352dn/LBP351dn BW LASER PRINTER

- Up to 65 ppm/ Up to 58 ppm
- 600 Sheets (Std.); 3,600 Sheets (Max.)
- 500 - 20K Recommended Monthly Page Volume
- All-in-One Toner Cartridge  
High Capacity: 25K Sheets



	Mobile Printing		Duplex Printing
	Mobile Scanning		Duplex Scanning
	Application Library		uniFLOW Online uniFLOW Online Express
	uniFLOW		uniFLOW Scan

# SUPPLIES, PRICING, AND SERVICE

A RESPONSIBLE WAY TO WORK.

## KEEP IT CANON

Canon GENUINE® consumables are:

- Evaluated and tested under extreme conditions
- Frequently redesigned and improved
- Manufactured worldwide, solely by Canon Inc. and its corporate affiliates

## USE CANON GENUINE® SUPPLIES

Canon GENUINE® consumables help provide:

- Longer life for your Canon equipment
- High yields
- Superb performance
- High-quality output
- Minimal jamming or malfunctioning of equipment



## COMPETITIVE PRICING AND PROMOTIONS

Canon imageCLASS offers:

- Competitive pricing
- Aggressive promotions
- Product bid support

## UNCOMPROMISING DEDICATION

Canon Service offerings include:

- Highly trained dealer support technician network
- Product reliability, service, and support
- 100%, U.S.-based call center staff
- Commitment to quick and easy resolution of all support issues
- Prompt and convenient service—advanced exchange, carry-in, on-site dispatch
- Extended service plans (eCarePAK) available for purchase



USA.CANON.COM



As an ENERGY STAR partner, Canon U.S.A., Inc. has certified these models as meeting the ENERGY STAR energy efficiency criteria through an EPA recognized certification body. ENERGY STAR and the ENERGY STAR mark are registered U.S. marks. Canon, imageCLASS, imageRUNNER, imageWARE, and the GENUINE logo are registered trademarks of Canon Inc. in the United States and may also be registered trademarks or trademarks in other countries. uniFLOW is a registered trademark of NT-ware Systemprogrammierung GmbH. All other referenced product names and marks are trademarks of their respective owners. Subscription to a third-party cloud service required. Subject to third-party cloud service provider's Terms and Conditions. Canon products offer certain security features, yet many variables can impact the security of your devices and data. Canon does not warrant that use of its features will prevent security issues. Nothing herein should be construed as legal or regulatory advice concerning applicable laws; customers must have their own qualified counsel determine the feasibility of a solution as it relates to regulatory and statutory compliance. Specifications and availability subject to change without notice. Not responsible for typographical errors. ©2020 Canon U.S.A., Inc. All rights reserved.

0920R5-WiCB-PDF-IH

